



INVESTORS BRIEFING

17 August 2017, 3:30 p.m.

Shangri-La at the Fort

Part 1 of 2

LRWC

INVESTOR BRIEFING

- I. Opening
- II. Introductions
- III. Welcome Remarks: Reynaldo P. Bantug Chairman & President
- IV. 2017 1H Financial Highlights – Riz Oades

COMPANY Updates

- V. First Cagayan – Jasper Vicencio
- VI. ABLE and TGXI – Al Alonte
- VII. LR Data – John Cornejo
- VIII. Midas Hotel & PIKI – Celine Lim
- IX. PIKI & Blue Chip – Eng Hun

- V. Q&A

DISCLAIMER

- Leisure and Resorts World Corporation (the “Company”) assumes no responsibility or liability regarding any action or any resulting decisions taken regarding any information presenting herein, resulting from unintentional errors or omissions contained in this document.
- Furthermore, this document contains results of operations and important financial information. It may also contain certain projections, plans, strategies, and objectives of the Company. Some do not refer to historical data and maybe considered as forward looking statements within the meaning of the relevant law.
- There are risks and uncertainties associated with forward-looking data. Future results and actual events as they transpire may be materially different from what is expected or indicated by the statements contained herein. No assurance is given that certain results may occur, or those indicated by any such forward looking statements, will be achieved.
- This document is not an offer to sell securities, nor a recommendation to buy nor a solicitation of an offer to buy or sell securities.



WELCOME REMARKS

REYNALDO P. BANTUG
CHAIRMAN & CEO



FINANCIAL HIGHLIGHTS

RIZALITO OADES

SVP & Group CFO



INVESTORS BRIEFING

17 August 2017
3:00 p.m.

Shangri-La at the Fort

DISCUSSION POINTS

NI Development

First Half 2017

Financial Position



Net Income Development



INVESTORS BRIEFING

17 August 2017
3:00 p.m.

Shangri-La at the Fort

NET INCOME DEVELOPMENT

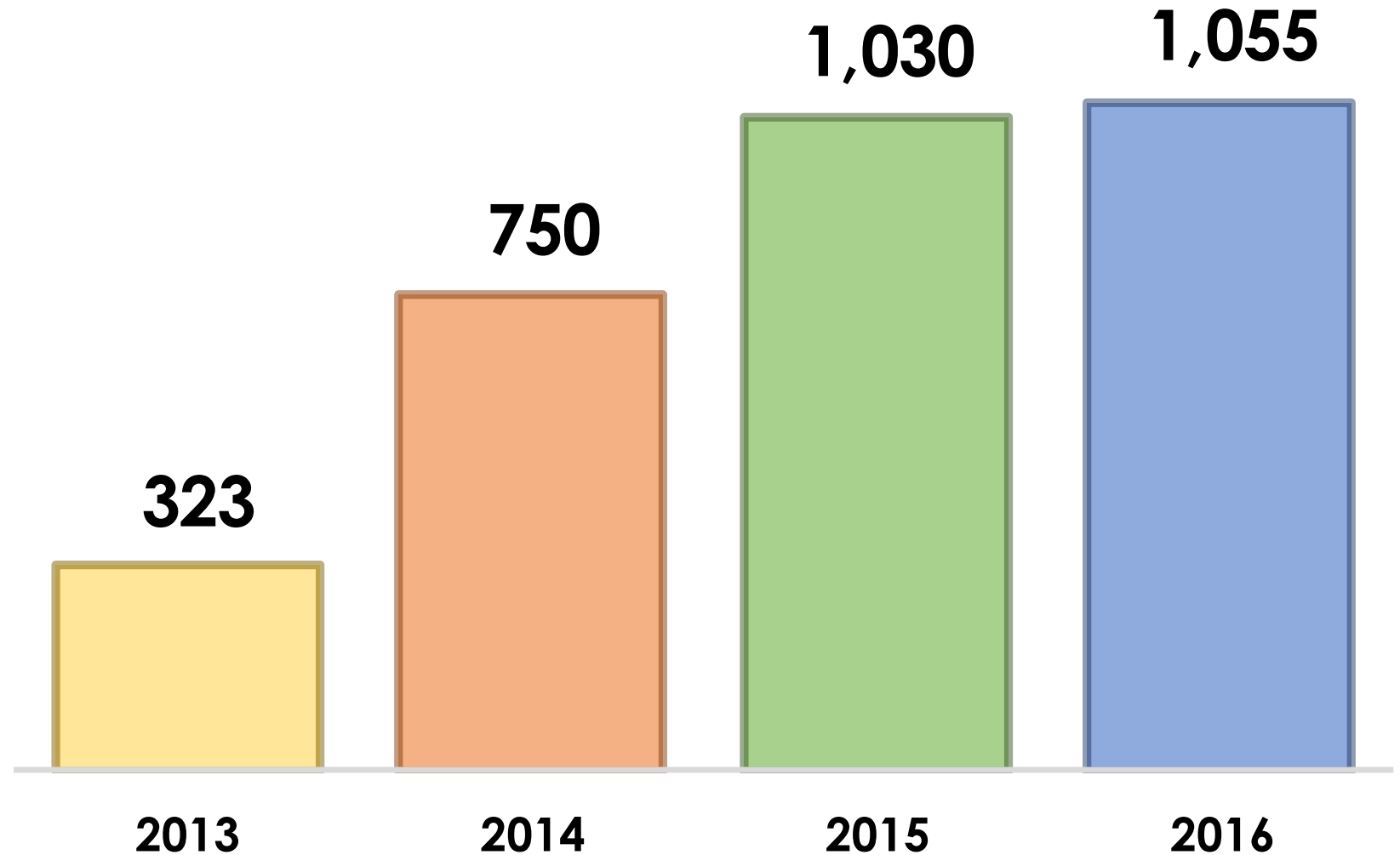



INVESTORS BRIEFING

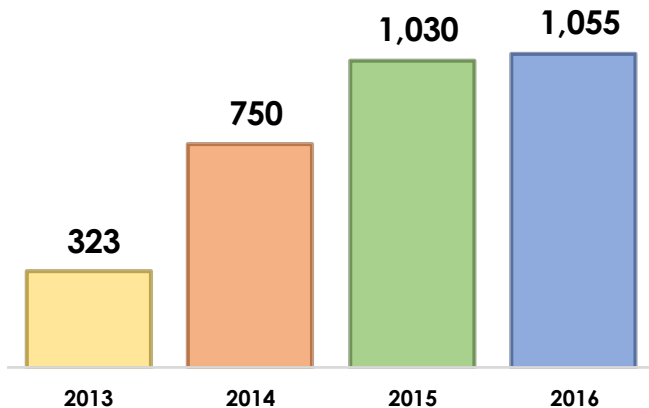

Shangri-La at the Fort

REGULATORY CHALLENGES

2016

New administration

Philweb's non-renewal

PAGCOR's POGO license

PAGCOR's proximity rule

2017

PAGCOR stricter rules

EO 13 (online jurisdiction)



First Half 2017

362M

↓ 239M or 40% decline

	% ownership	CY	PY	Grw	%
CONSO		362	600	(239)	-40%
CASINO		130	71	59	84%
ONLINE		84	331	(246)	-74%
RETAIL		123	219	(97)	-44%
PROPERTY		180	121	59	48%
PARENT		(155)	(141)	(14)	-10%
BCGLC	Arcade 100%	82	19	63	325%
PIKI	Junket 100%	27	15	12	81%
HEPI*	Hotel/Casino 51%	20	36	(16)	-44%
FCLRC	Hosting fees 70%	18	288	(270)	-94%
LRDCSI	Infra services 80%	67	43	24	57%
ABLE	Bingo 100%	118	215	(97)	-45%
TGXI	eCasino 100%	5	4	1	17%
ABLGI	City of Dreams 100%	166	115	51	45%
LRLDI	Comm Space 100%	(2)	12	(14)	-118%
TPI*	Office building 50%	16	(5)	21	405%

*equity share in associate/joint venture

1H 2017 NET INCOME

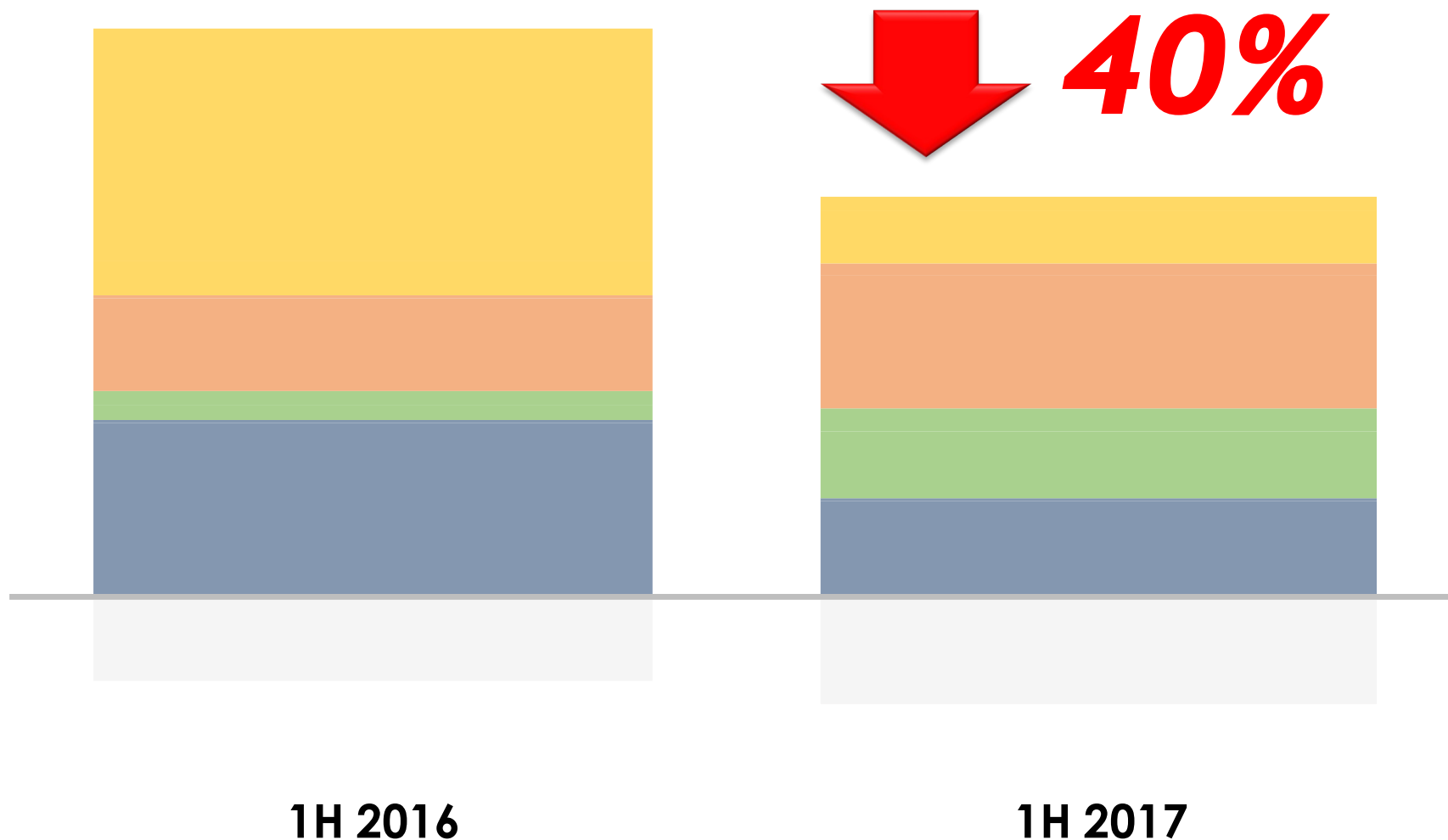

362M

↓ 239M or 40% decline

Online 74% ↓

Retail 44% ↓

Casino 84% ↑

Property 48% ↑

1H 2017 NET INCOME

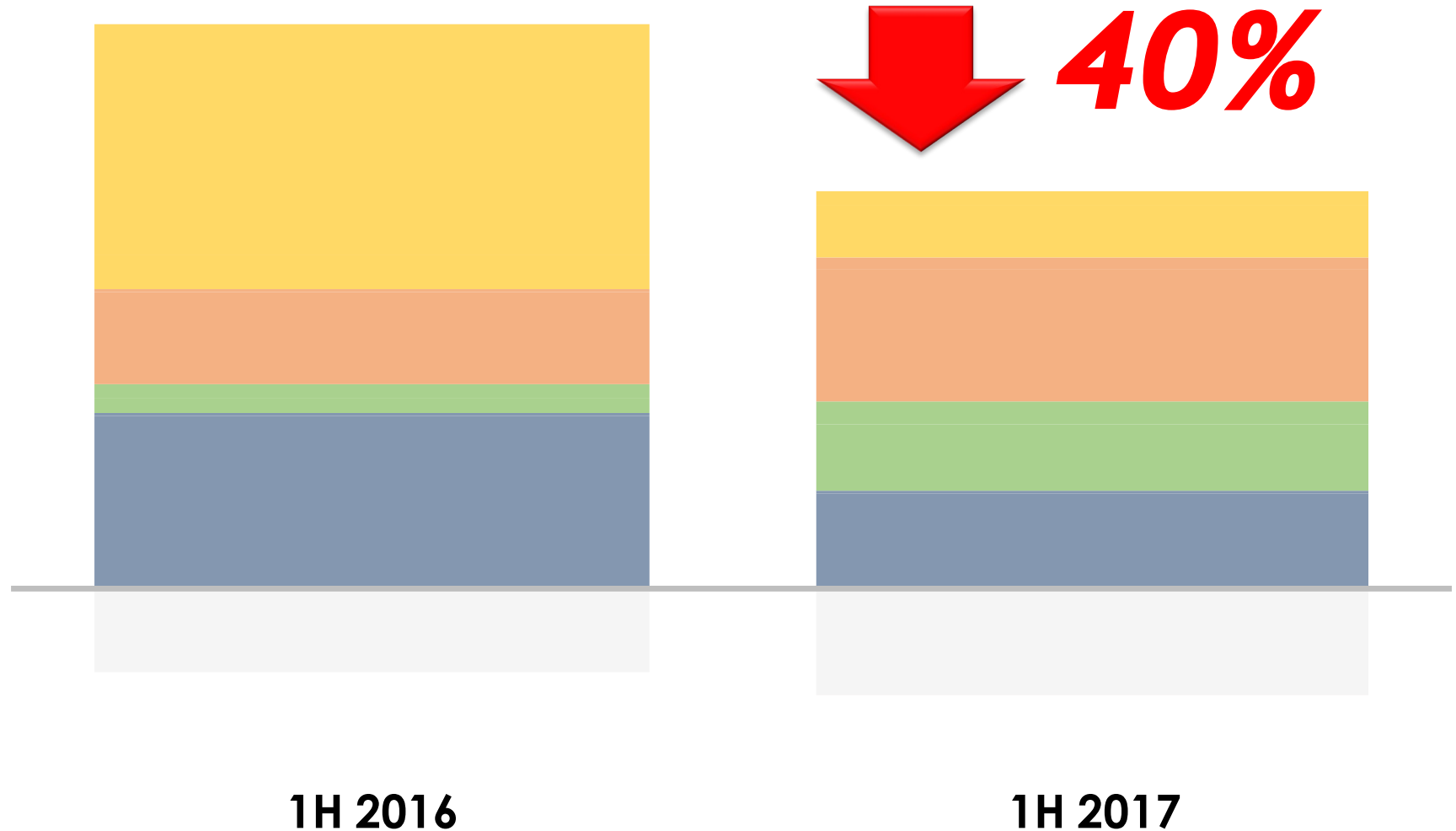



344M

↑ 32M or 10% growth

Online 57% ↑

Retail 44% ↓

Casino 84% ↑

Property 48% ↑

1H 2017 NET INCOME

(without FCLRC)

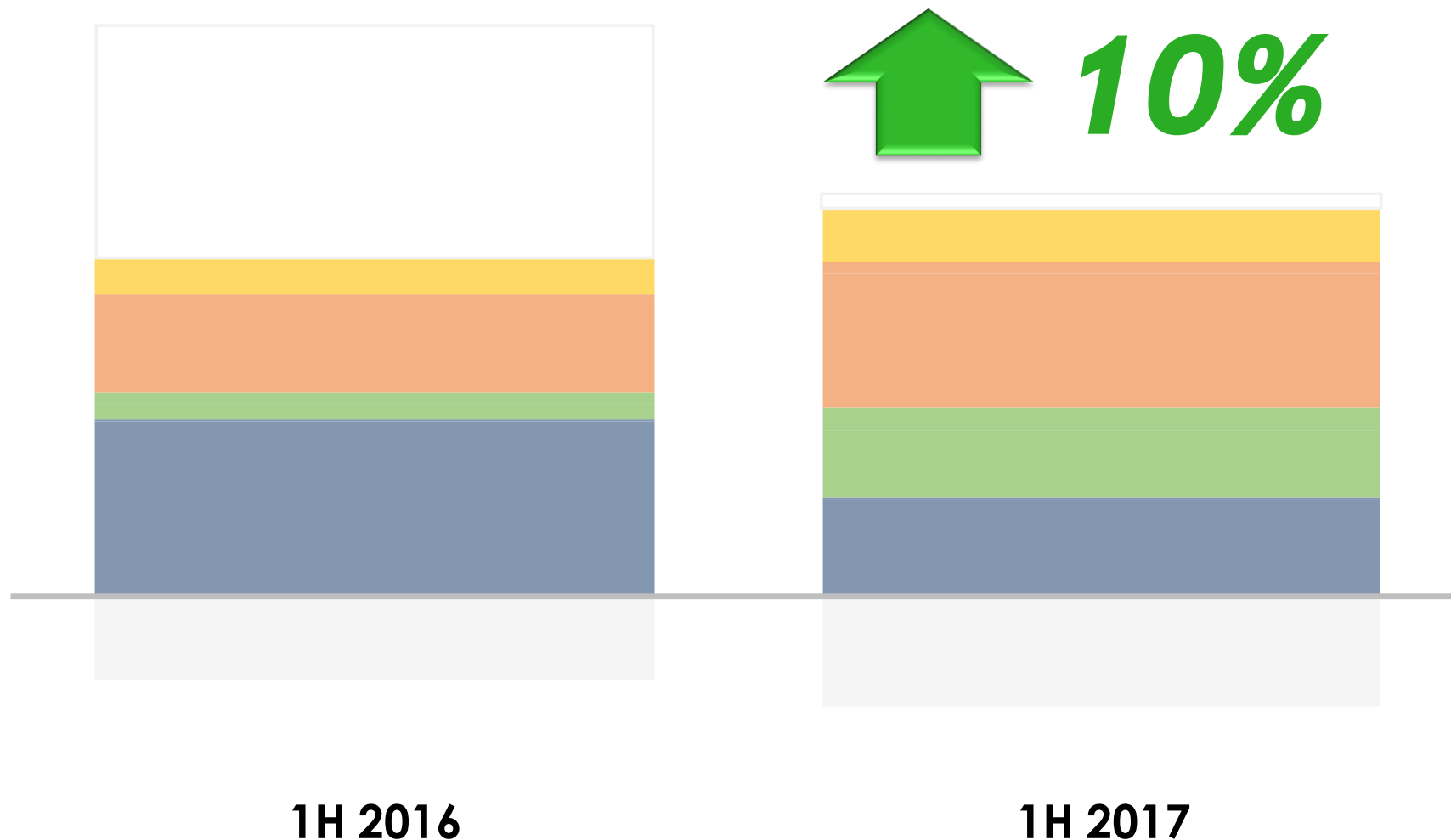

344M

↑ 32M or 10% growth

	% ownership	CY	PY	Grw	%
CONSO		344	312	32	10%
CASINO		130	71	59	84%
ONLINE		67	43	24	57%
RETAIL		123	219	(97)	-44%
PROPERTY		180	121	59	48%
PARENT		(155)	(141)	(14)	-10%
BCGLC	Arcade 100%	82	19	63	325%
PIKI	Junket 100%	27	15	12	81%
HEPI*	Hotel/Casino 51%	20	36	(16)	-44%
LRDCSI	Infra services 80%	67	43	24	57%
ABLE	Bingo 100%	118	215	(97)	-45%
TGXI	eCasino 100%	5	4	1	17%
ABLGI	City of Dreams 100%	166	115	51	45%
LRLDI	Comm Space 100%	(2)	12	(14)	-118%
TPI*	Office building 50%	16	(5)	21	405%

*equity share in associate/joint venture

1H 2017 NET INCOME

(without FCLRC)

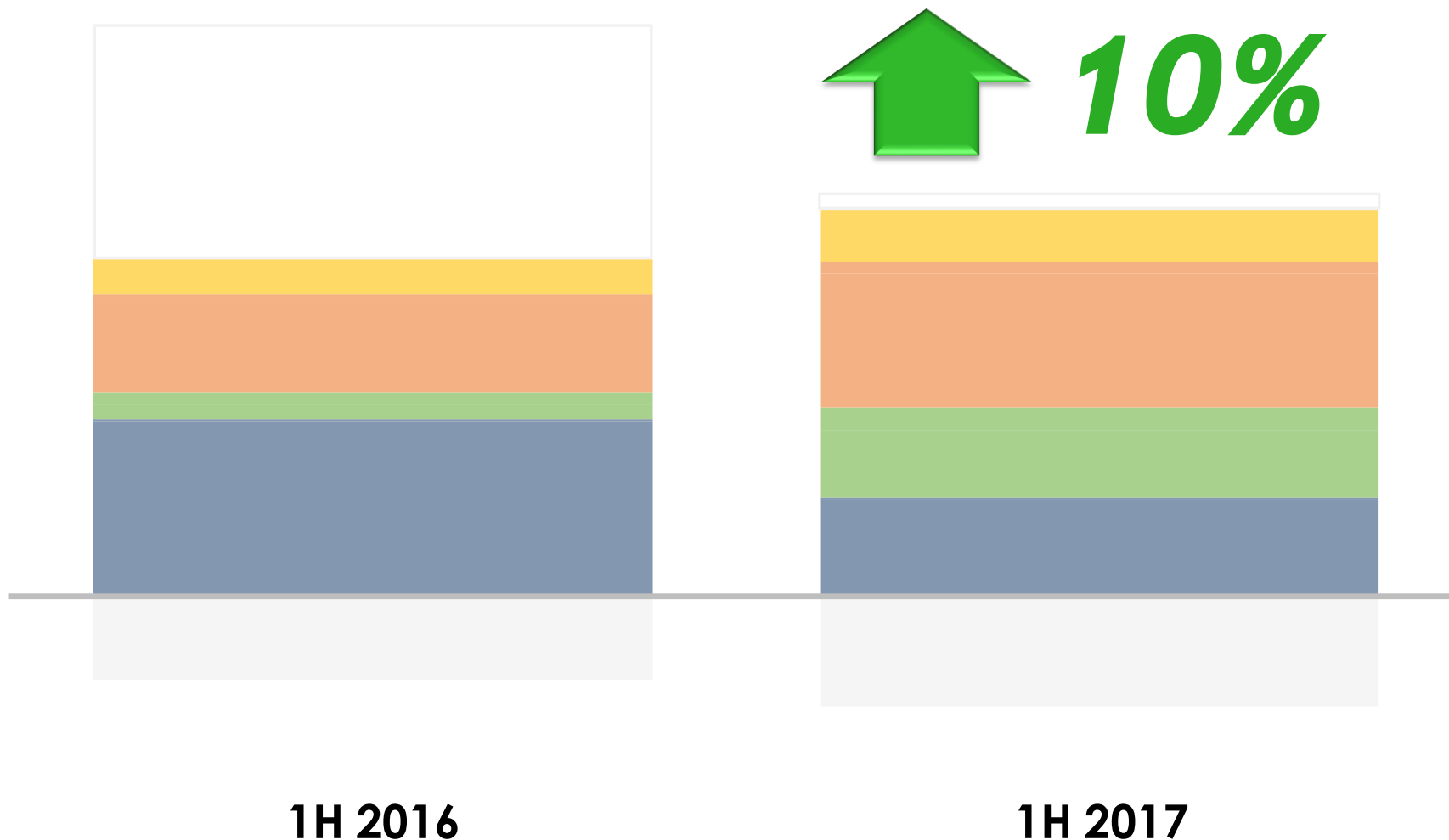

1H 2016

1H 2017



Financial Position



INVESTORS BRIEFING

17 August 2017
3:00 p.m.

Talisay A&B
Shangri-La at the Fort

BALANCE SHEET

	Jun2017	Dec2016	Dec2015		Jun2017	Dec2016	Dec2015
ASSETS				LIABILITIES			
<i>Current Assets</i>				<i>Current Liabilities</i>			
Cash	1,504	713	339	Accounts and other payables	1,395	794	1,855
Receivables	1,036	4,499	778	Short-term loans payable	1,084	1,189	1,211
Prepayments and other CA	168	298	267	Current portion of LT loans	174	2,943	720
	2,708	5,510	1,384	Income tax payable	185	129	98
<i>Noncurrent Assets</i>					2,838	5,055	3,885
Property and equipment	2,179	1,859	1,531	<i>Noncurrent Liabilities</i>			
Investment properties - net	130	136	144	LT loans - net of current	354	436	3,359
Investments and advances	2,879	2,971	3,142	Retirement benefits liability	107	150	126
Advances to Belle	-	-	4,780	Other noncurrent liabilities	4	4	4
Goodwill	1,484	1,453	1,453		465	591	3,489
Other noncurrent assets	1,119	929	1,163				
	7,791	7,347	12,213	EQUITY			
					7,197	7,211	6,223
TOTAL ASSETS	10,500	12,858	13,597	TOTAL LIABILITIES & EQUITY	10,500	12,858	13,597

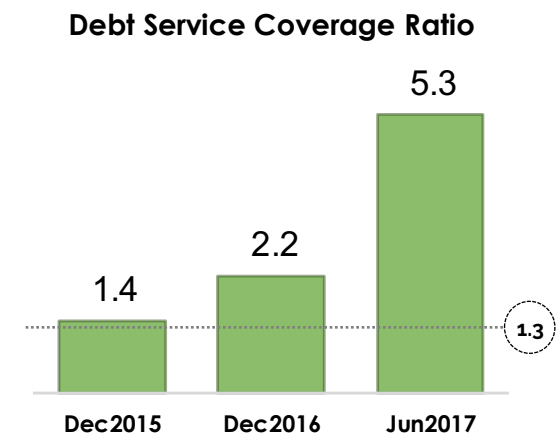
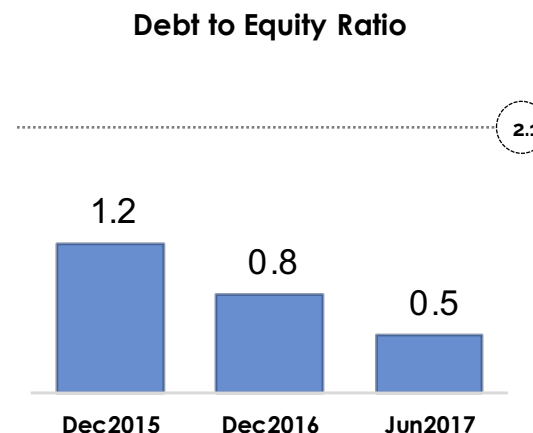
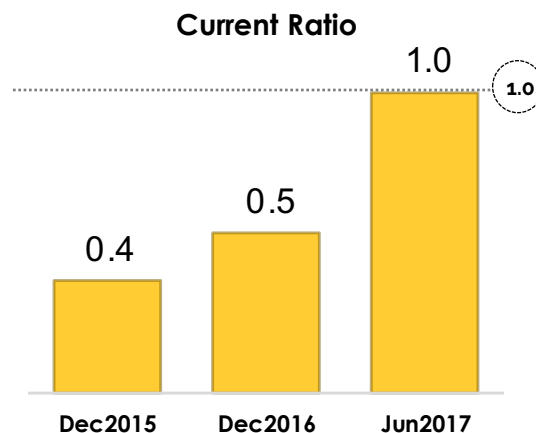

INVESTORS BRIEFING

17 August 2017
3:00 p.m.

Talisay A&B
Shangri-La at the Fort

RECAP

Net Income Development

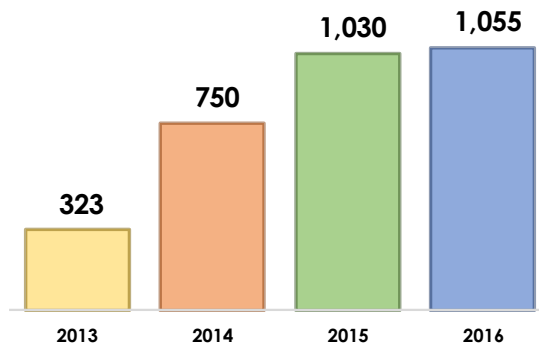

1H 2017 Net Income

with FCLRC

without FCLRC

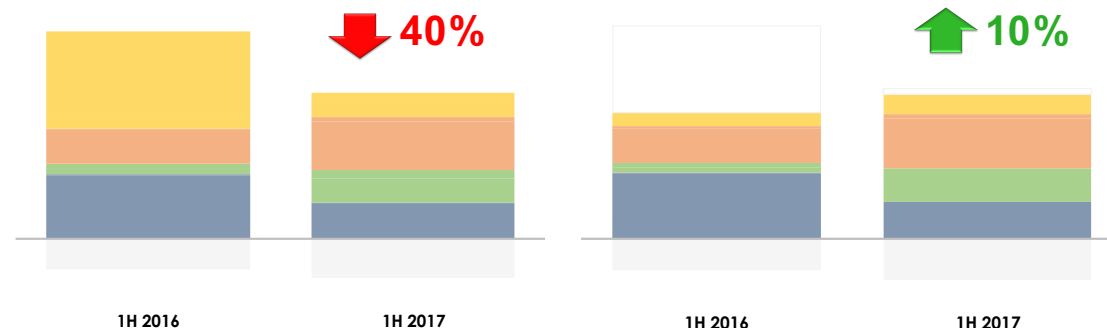

Current Ratio

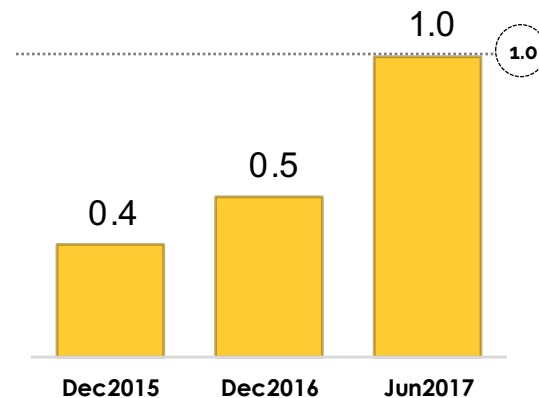

Debt to Equity Ratio

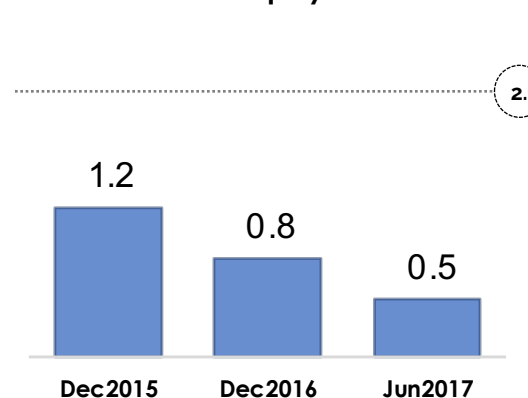

Debt Service Coverage Ratio

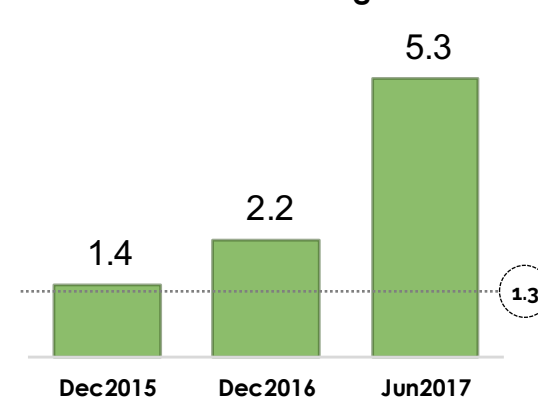



FIRST CAGAYAN LEISURE & RESORTS CORPORATION

JASPER VICENCIO



Executive Order 13 Update

Highlights:

- Sec. 1: PNP and NBI in coordination with DOJ, DILG, DICT to intensify fight against illegal gambling
- Sec. 2: All gambling activities and services related to or in support of such activities **conducted beyond the territorial jurisdiction of the government authority which issued the license shall be dealt as illegal gambling**



Executive Order 13 Update

Highlights:

- Sec. 3: Any gambling operator desiring to operate outside the jurisdiction of the government authority which issued its existing license **shall apply for a separate license with the appropriate authority.**



PEZA Update

PEZA:

- Locators will be permitted to locate in PEZA buildings provided they fall under EO 13
- CEZA and APECO to get POGO license from PAGCOR in order to operate in PEZA building

Cyberpark Site Development Plan

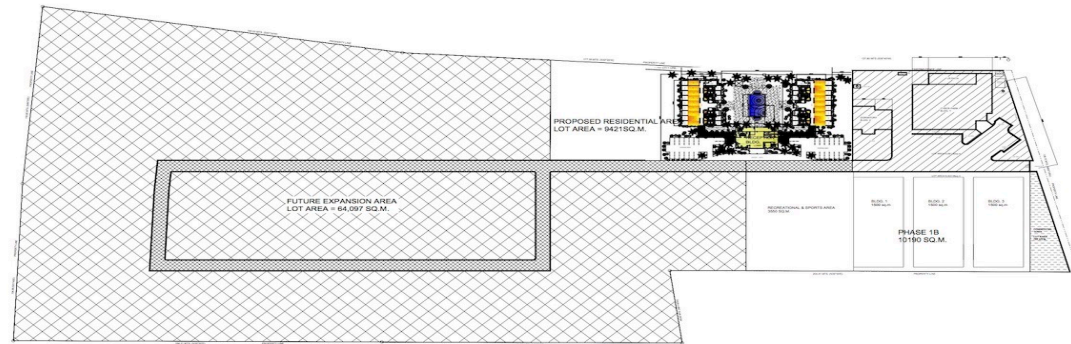

CYBER PARK
PROPOSED SITE DEVELOPMENT PLAN

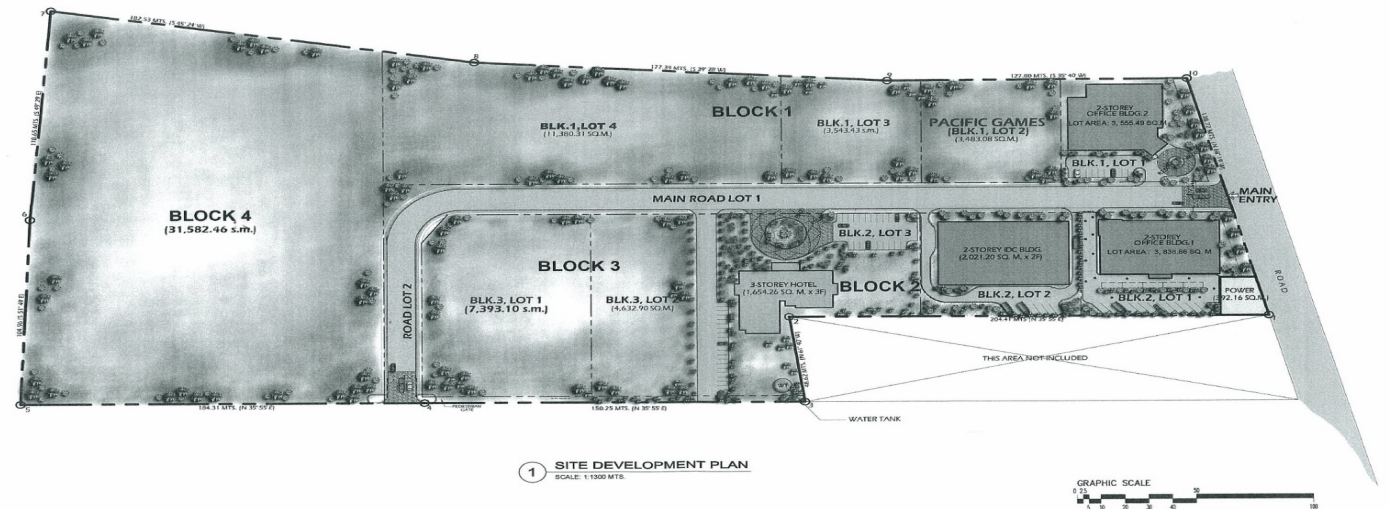

Cyberpark Planned Phases

- Phase 1A — Completion of the Cyberpark Building 1 & 2 renovation and ready for turnover to a new locator, Empire Group
- Phase 1B — Proposed Development of Commercial and Residential Area
 - Construct a Data Center estimated cost of P300M at 50 rack capacity
 - Construct 2-3 storey buildings with gross floor area of 4,500 sq.m. each
 - Provide area for park and recreational facilities
 - Construct residential units (30 container type units)
- Future Phase — Development of the Remaining 64,000 sq.m.
 - Divide the area into 3 super blocks of ~2 hectares
 - Each super block has a buildable land area of ~14,000 sq.m.
 - Provide road network and utilities as required

Cagayan North International Ainort

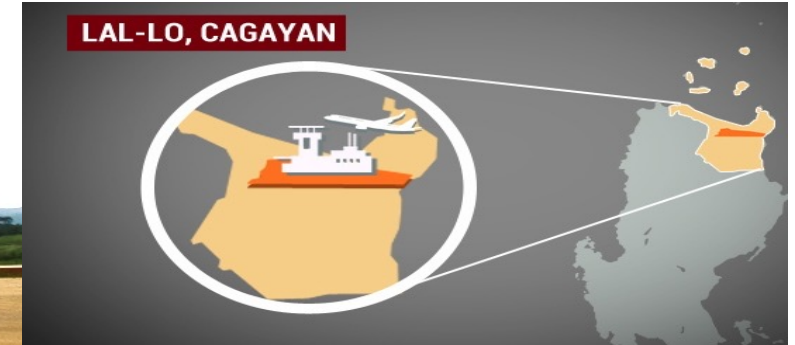

- 2.1km long runway with a CAAP approved a Temporary Aerodrome Registration 3C up to November 12, 2017
- On-Going Works:
 - PAPI Lights, RESA, Strip Width, Air Traffic Console, Weather Equipment
- First Chartered Flight from Macau expected on Third Quarter, 2017



LR DATA CENTER SERVICES INC

JOHN CORNEJO



2017

Service Framework and Roadmap

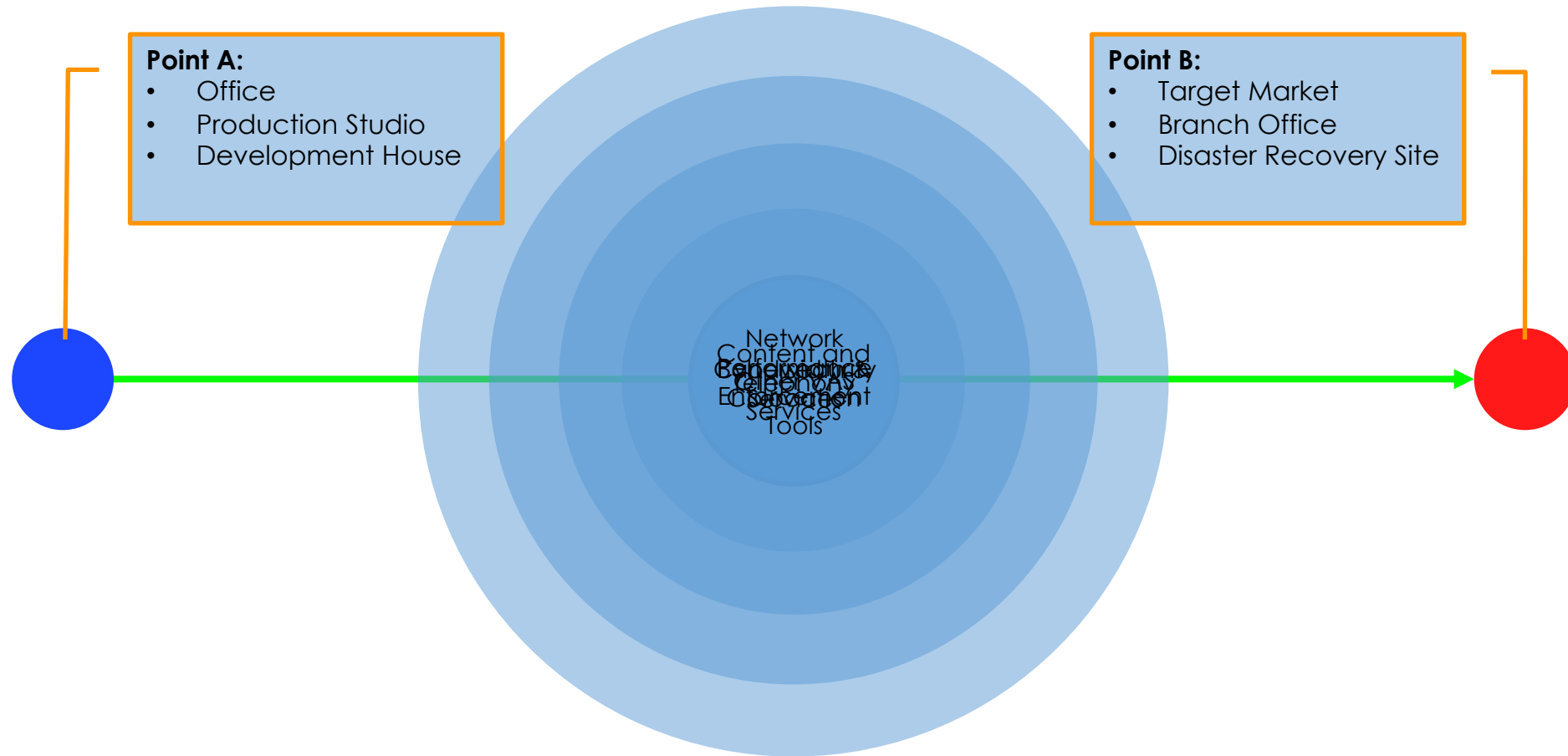

2017 Business Performance Highlights

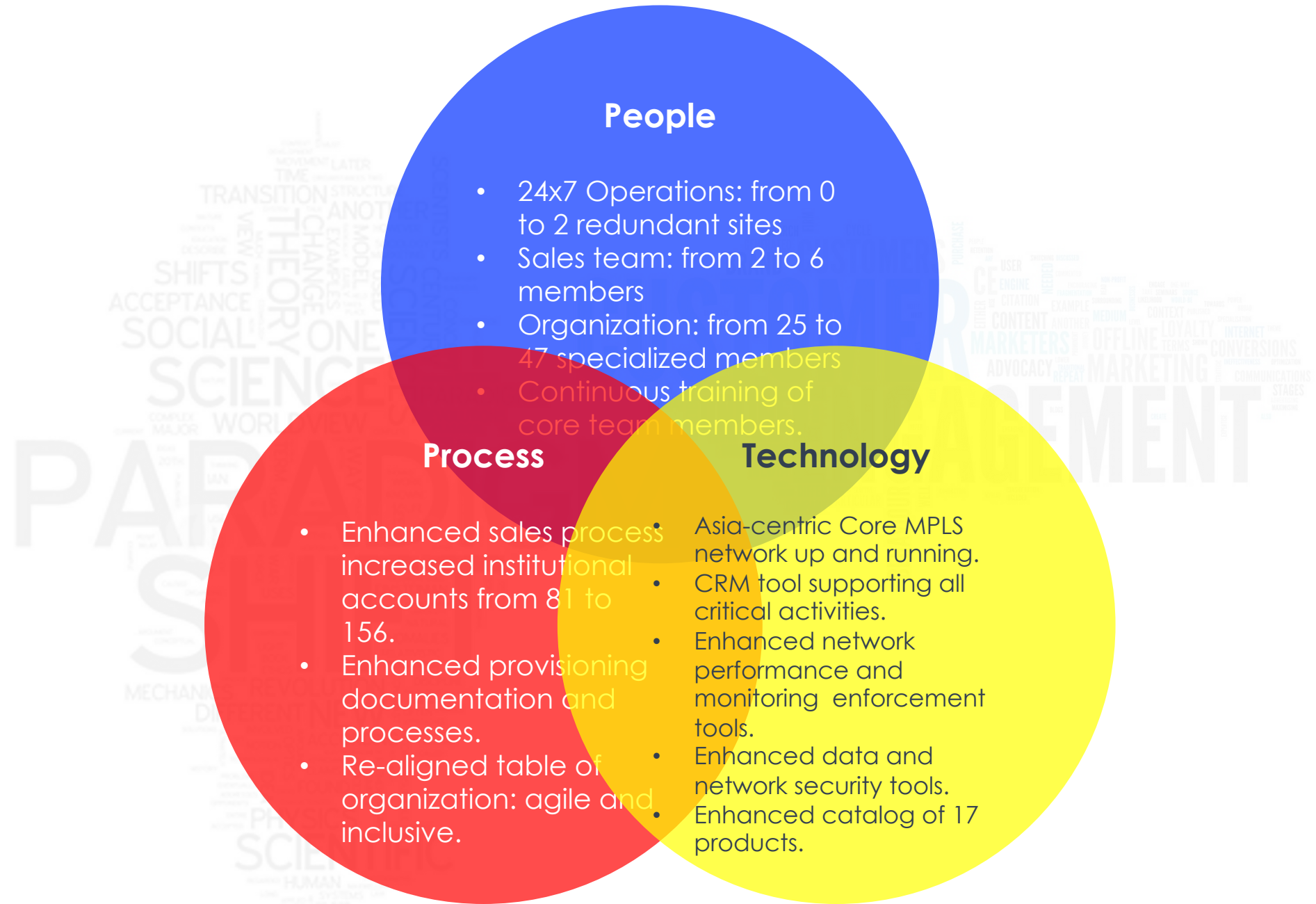

Opportunities

- Mobile Devices: platform and device-centric approach
- Growing Asian Markets: bespoke services
- Dispersed Customers: macro economies of scale
- Service Fragmentation: enhanced VAS
- Strategic Partnerships: global service availability



Network Infrastructure

The map illustrates the network infrastructure of the Philippines, highlighting its strategic position as a global data hub. Key features include:

- Submarine Cable Landing Stations:**
 - North:** BALLESTEROS SUBMARINE CABLE LANDING STATION (TGN-IA), STA. ANA, CAGAYAN.
 - West:** LA UNION SUBMARINE CABLE LANDING STATION (AAG).
 - South:** CAVITE SUBMARINE CABLE LANDING STATION, BATANGAS SUBMARINE CABLE LANDING STATION, DAET SUBMARINE CABLE LANDING STATION.
- International Connections:**
 - TO EUROPE:** LONDON, PARIS, DUBLIN, ISLE OF MAN, GIBRALTAR, GUERNSEY, MALTA, LISBON.
 - TO HONG KONG:** HK TO TAIWAN, HK TO CHINA.
 - TO JAPAN:** JAPAN, HONGKONG, SINGAPORE, MALAYSIA.
 - TO TAIWAN:** TAIWAN, HONGKONG, SINGAPORE.
- Data Centers:**
 - CYBERPARK CEZA:** FCC DATA CENTER.
 - MK1:** DATA CENTER.
 - TECH ZONE:** DATA CENTER.
 - RCBC PLAZA:** DATA CENTER.
 - BGC:** DATA CENTER.
 - VITRO:** DATA CENTER.
- Fiber Optic Ring Cable:** A network of fiber optic cables connecting the various landing stations and data centers across the country.

Site Development

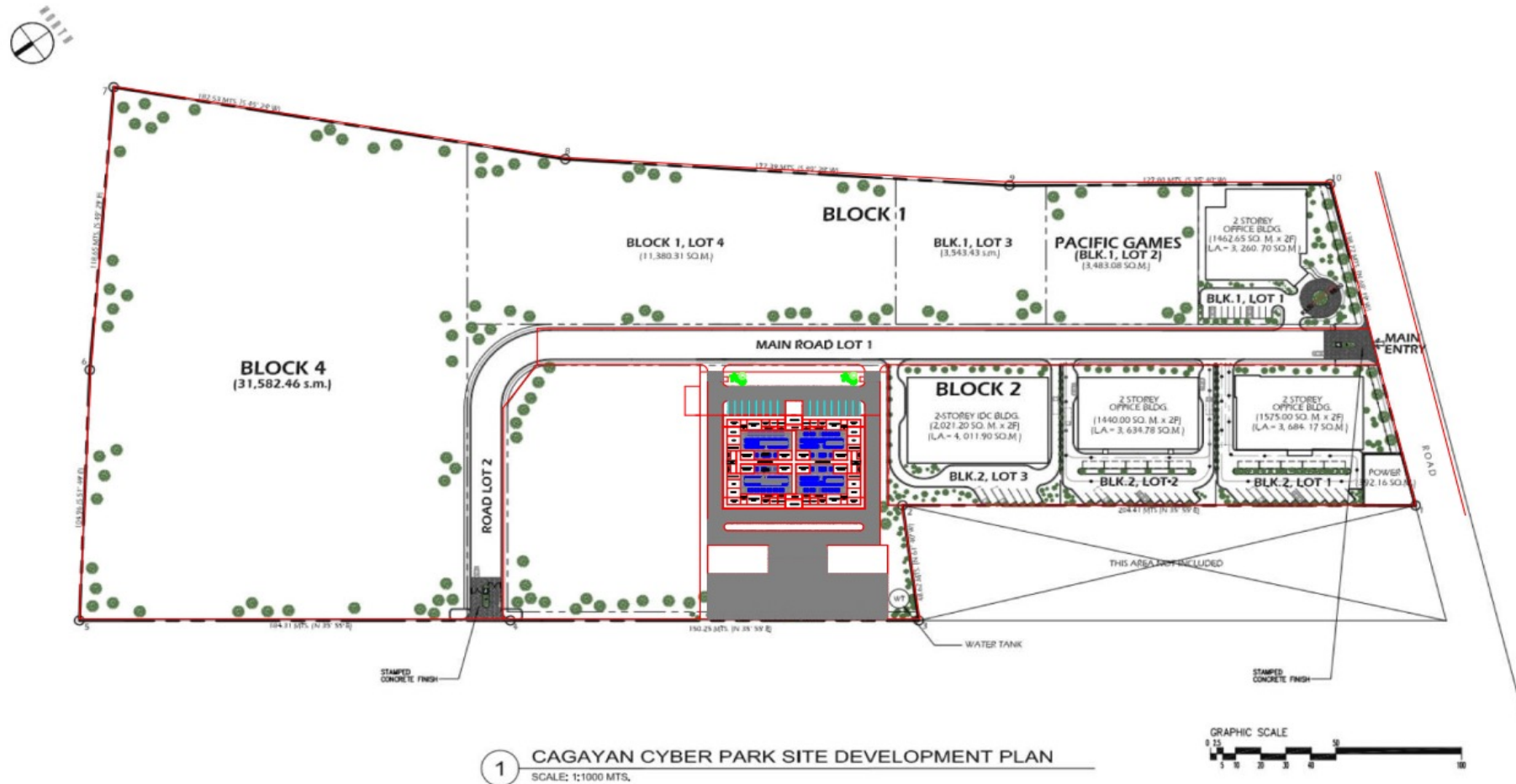

Site Development

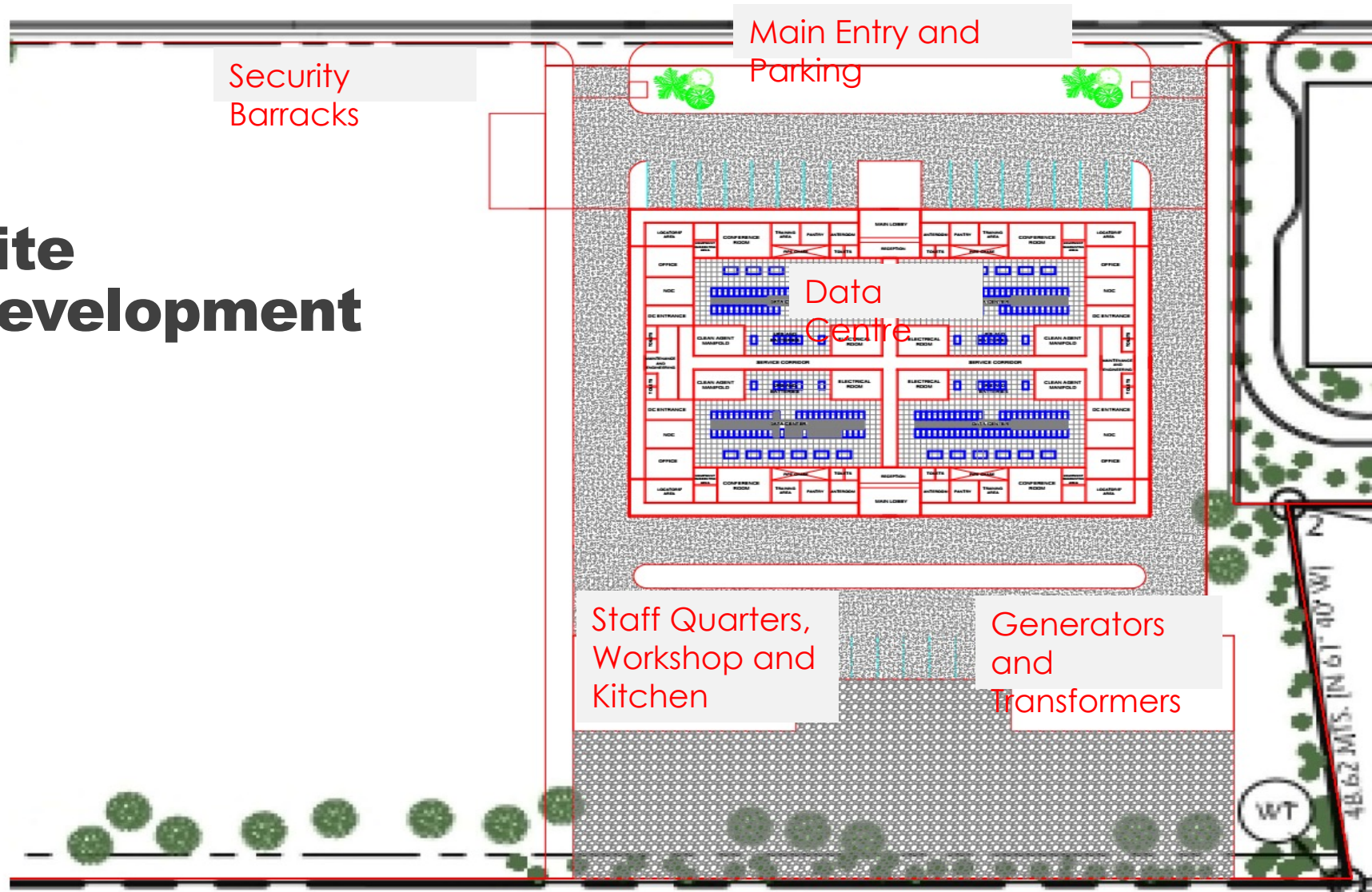



**Perspective for 50 Racks (Phase
1)**



 **Perspective for 100 Racks
(Phase 1 and 2)**

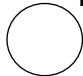

 **Perspective for 150 Racks (Phase
1, 2 and 3)**

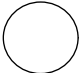

 **Perspective for 200 Racks (Phase
1, 2, 3 and 4)**

Service Catalog

Network Services

1. IP Transit or Global Internet Access (GIA) via Multiprotocol Label Switching (MPLS) and multiple network-to-network-interfaces (NNI) with Tier 1 providers.
2. Domestic Local Loop (DLL)
3. International Private Leased Circuit (IPLC)
4. Direct Routes: bespoke layer 2 or 3 services to Europe, China, Cambodia, Hong Kong, Taiwan, Korea, Malaysia, Japan, and others.
5. Clean Pipe Service: zero backholing of circuits with guaranteed data throughputs.
6. Content Delivery Networks (CDN): CDN to multiple global destinations.
7. Network Performance Enforcer (NPE) service through a Customer-Premise Equipment (CPE) allowing fully-outsourced, off-net, 24x7 network monitoring services for up to layer 7 management. Includes layer 7 DDoS detection and mitigation. Takes the place of 24x7 by 52 weeks of shifting Network Engineers.

Data Center Services

1. Colocation: through multiple high-performance data centers in the Philippines, with options for Disaster Recovery and/or High Availability sites across Asia and Europe.
2. Full looking glass and remote hands services across all data center sites.
3. Infrastructure as a Service: hardware leasing and management services.
4. *Virtual Private Cloud (VPC): dedicated and secure cloud services with local and offshore instances.

Security Services

1. Secure Domain Name Servers (Hardened ANS and recursive DNS): website security and acceleration, protection against DNS poisoning, DNS DDoS, malware and viruses, among others.
2. DDoS Detection and Mitigation: complete on-premise and cloud solution with multiple Tbps and PPS of mitigation capacity.
3. Vulnerability assessment: website scans, code audits, penetration testing, and infrastructure security audits.
4. Anti-phishing, spoofing and website takedown services: mitigation and takedown of fake websites.

Other Services

1. Licensed China TV Box: over 120 channels of licensed content from China, to include live/broadcast TV.
2. Telephony Services: DID, ITFS, VoIP, IVRS, ACD, and others.